

DESCRIPTION
**DATA SHEET INDICATING TECHNICAL DETAILS FOR SCREW
MOUNTABLE SADDLE TYPE MOUNTS.**

PART NUMBER:
SM 2

DRAWN BY: **TIM W**

SIGNED: *TW*

ISSUE DATE: **20-11-2014**

DRAWING SCALE SIZE: **N/A**

SHEET **1** of **1**

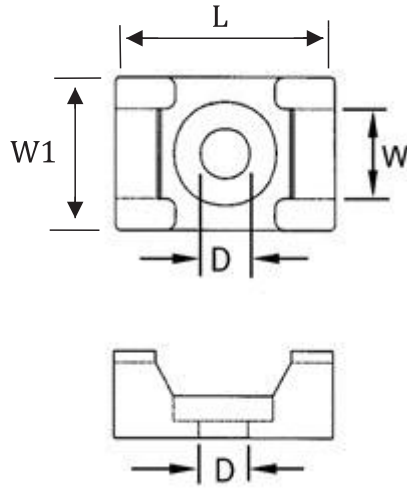

Partex Part Number.	SM 2
Material.	Nylon 66
Temperature Rating.	-40°C to 85°C
W	5mm
W1	10.3mm
L	15.8mm
D	3.9mm
Pack Quantity.	100
AVAILABLE COLOURS	Black & Natural

For use with standard nylon cable ties upto 4.8mm width.



REV 1	DATE		SIG.
REV 2	DATE		SIG.
REV 3	DATE		SIG.